



[www.litprints.co.uk](http://www.litprints.co.uk)

## Dear Customer

Thank you for your purchase of our OO Gauge Farm Barn kit. It has been designed to fit together with glue. Use the guide below for assembly.

Tools required: Glue (Note: use fast activating glue.)

### ASSEMBLY INSTRUCTIONS.

1) Prepare and check kit. Glue the side panels to the truss legs as shown below. Do this for both sides.

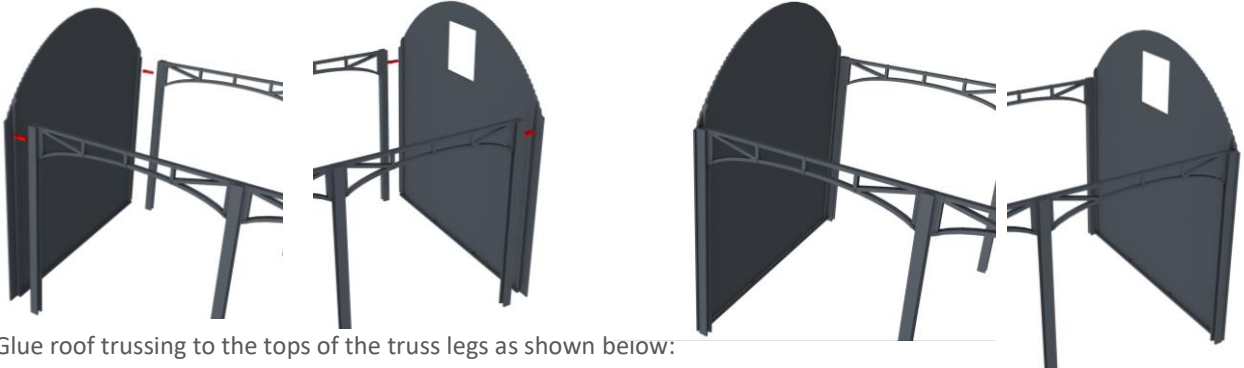

2) Glue roof trussing to the tops of the truss legs as shown below:

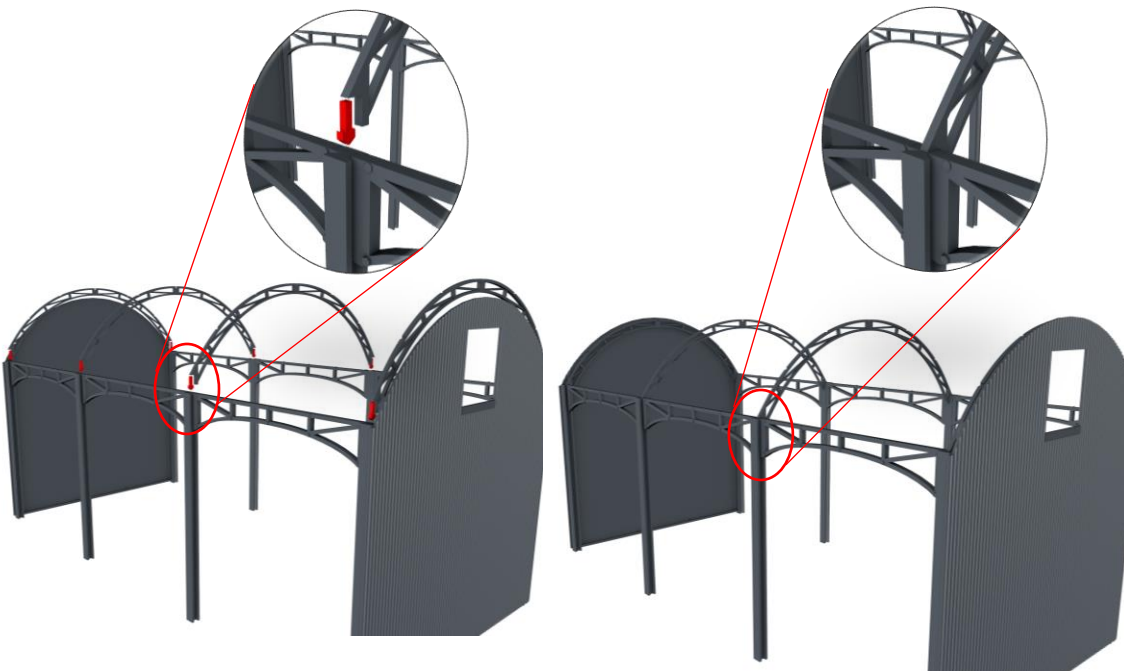

3) Slide the back panel on to the model from the underside. The back panel has grooves at the bottom that slot into the truss legs. See imagery below.

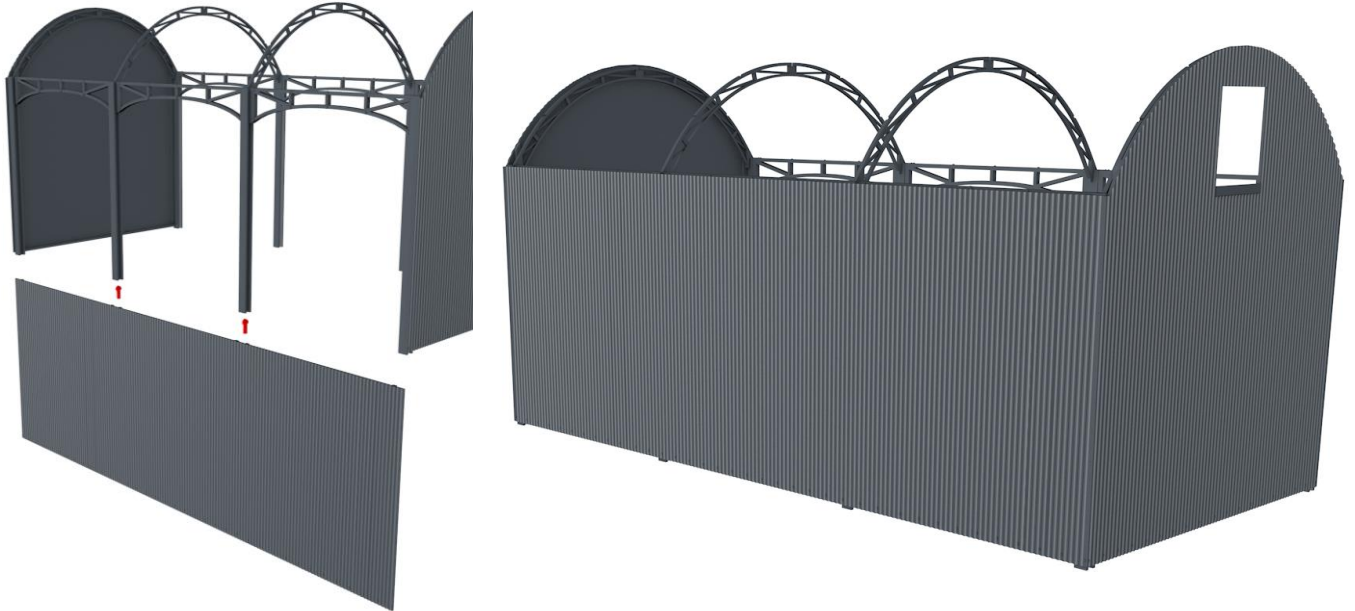

The imagery below shows how the back panel slots into the truss legs near the base. The panel still needs to be glued.

The image on the far right shows a birds eye view of the corner.



4) This next part is optional, you can add the roof truss beam to the roof trussing, sometimes the beam needs trimming to correct length. See below for positioning.



5) Once the basic structure is complete its time to add the roof.

Use the next set of imagery to position roof and glue in marked out spots (mid image). In addition, adding glue on the tops of the roof trussing also keeps the roof in place along the middle of the structure. Do a dry run before adding glue and trim any excess plastic.

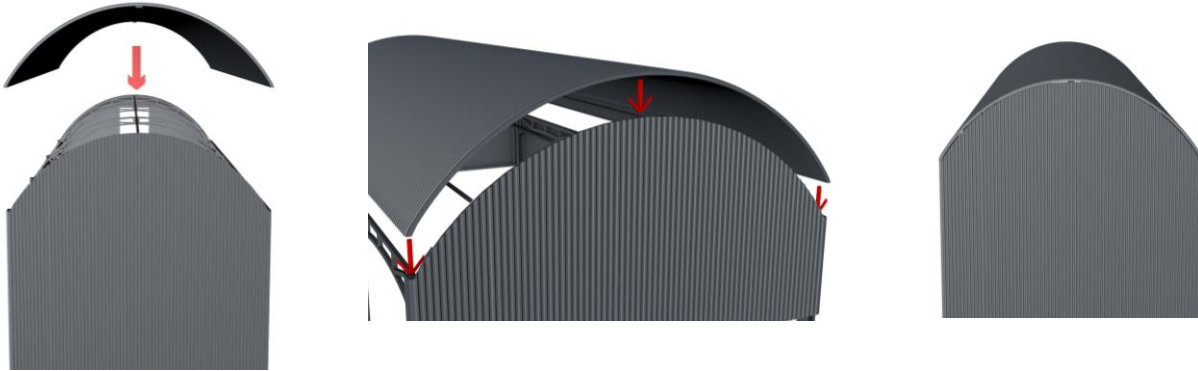

6) In this last step you need to add the guttering as shown below:



Contents:

Back panel x1



Side panels 1 each

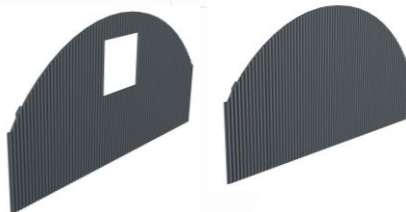

Roof x1



Truss legs x2



Roof Trussing B x4



Roof beam x1



Guttering x1

