



www.litprints.co.uk

Contents:

x6 1 ASP hood



x4 Truss



x1 Handrails



x4 Leg Base



x1 Number Plate



x4 Wire Cover

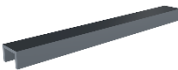

x4 Leg top



x1 Truss mount



x1 Truss mount with wire feed



x2 Legs and x1 ladders



x18 LEDs (6 green 6 red 6 yellow)
& x21 Thin Cables

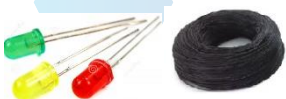

Dear Customer

Thank you for your purchase and interest in our OO Gauge 5-6 Track Signal Gantry kit.

It has been designed to fit together with glue and to be wired for animated look.

This is a UK Type aspect signal that covers up to 6 tracks.

Tools required: glue, soldering iron, solder



ASSEMBLY INSTRUCTIONS.

1) First prepare the LEDs for soldering and cabling. Use 3 cables for the 2-light system and 4 cables for the 3-light system.

2) Join the negative prongs to one cable for each set of LEDs, then solder a cable to all the positive Prongs individually. **Note: the long prong on the LED is positive. (3-5V only)**

1ASP: Positive + Negative -



3) Once LEDs and cables have been soldered, Slot them into the ASP hoods in the order like the images above.

4) Fold each rail up and glue the handrails together: use a ruler along the folding seems to assist.

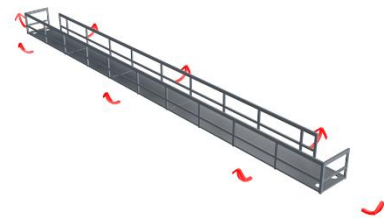
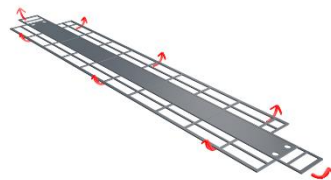

5) Glue the parts together as shown on the right.
Make sure the smooth backs of the legs are facing inwards.

(Parts needed: Legs, leg base and leg top)

6). Prepare truss sections. It is possible to cut down the truss length to match your designed track length.
2-6 track is possible, but we recommend 5-6 track for realism.

Glue truss parts to Truss mounts as shown. Add legs as shown. Keep orientation as shown in image D and E so the wire feed is on the correct side. Truss with wire runs needs to be on the left of the truss. (Image E has the cable runs/holes shown)

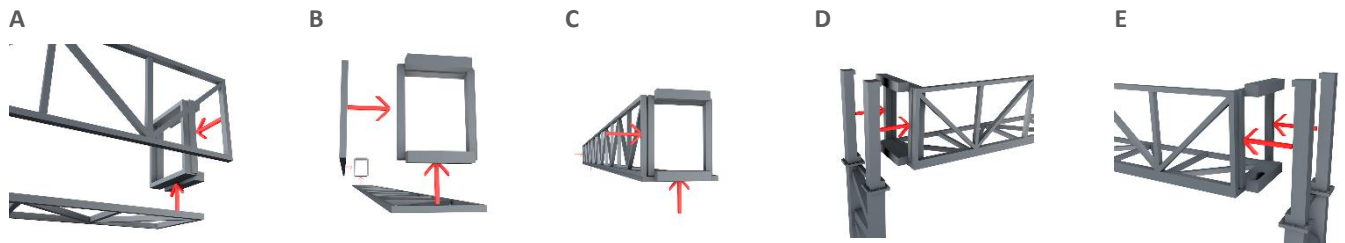
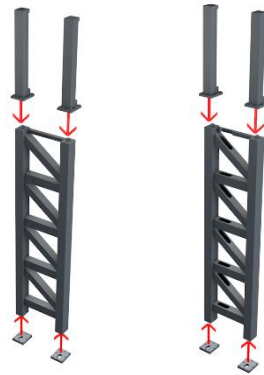

7) add walkway as shown below



8) Glue the ASP hoods into locations as shown in the image above on the right. Feed wires along one side of the walkway and into the wire runs down the leg. Add cable cover as shown below in A, then glue final 2 parts of the gantry into place as shown in B.

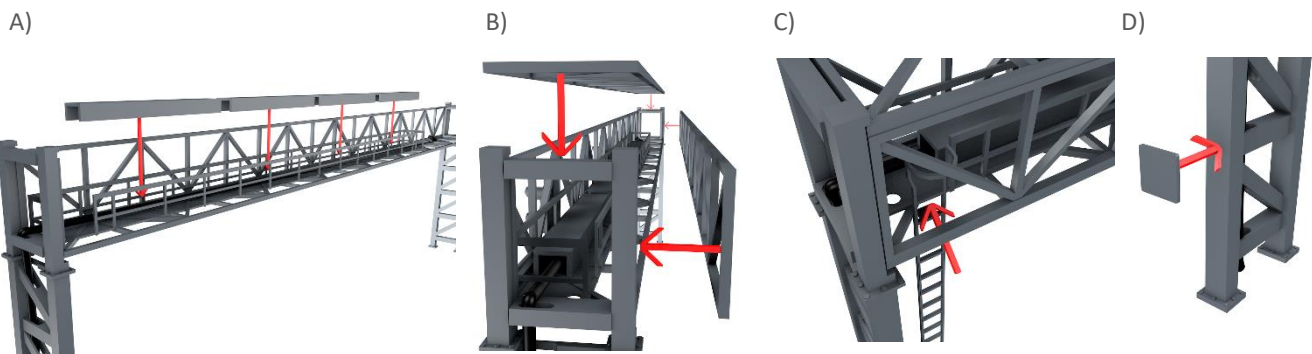

9) Lastly glue the ladder and as show above in image C. Add the number plate to one of the legs as seen in image D. You can also add the Overhead line equipment to any track that requires it. Once complete wire this up to your chosen controller.